

Iso-Flex® 2 Hour Rated J Series Winged Expansion Joint System

PRODUCT DESCRIPTION

The 2 hour rated (UL) Iso-Flex "J" Series Winged Expansion Joint System consists of a thermoplastic compartmentalized, elastomeric, compression seal with integral perforated wings.

The system is continuously bonded into a concrete breakout with Iso-Flex 900 Elastomeric Concrete header material.

The system is coupled with a 2 hour rated fire blanket assembly that is compressed in-place below the expansion joint assembly.

BASIC USES

The 2 hour (UL) rated Iso-Flex J Series Winged Expansion Joint System is utilized in fire rated floor construction in order to provide the necessary UL 2079 rating and to seal expansion joints exposed to wheel and/or pedestrian traffic. Typical application is in parking structures, stadiums, plazas, and other types of concrete structures where 2 hour fire rated expansion joints are required.

ADVANTAGES

- The UL 2079 rating confirms the system ability to withstand cycling and heat effects of a 2 hour rated floor assembly.
- The winged seal is bonded into a flexible, elastomeric concrete header that provides a continuous watertight anchoring system.
- The rated system enables use in concrete floor construction as thin in profile as 5" for max. gaps of 4.5" and 6" thickness for max. gaps of 7"
- Unique seal design maintains a flush surface, hence making it less susceptible to damage from normal, everyday traffic and abusive snowplowing practices.

UL FIRE RATING

- The 2 hour rated Iso-Flex Winged Expansion Joint Sealing System has met Underwriters Laboratory UL2079, class II testing. The assemblies were tested in full scale furnaces in the UL lab in compliance with UL2079, class II which includes system cycling prior to the 2 hour burn test.
- The UL listings include; XBHN-FF-D-1102 and XBHN-FF-D-1103.

LABORATORY TECHNICAL DATA

(Field Properties May Vary)

Property	Test Method	Seal	Iso-Flex 900
Tensile Strength	ASTM D412	1010 psi (67A)	1680 psi
Elongation @ break	ASTM D412	450% (67A)	240% min
Tear Strength	ASTM D624	138(67A)	195 lbs/inch
Brittle Point, °F	ASTM D746	-76 (67A)	_____
Compression Set 168 hrs. @ 73°F	ASTM D395	23% (67A)	_____
Compression Set 168 hrs. @ 212°F	ASTM D395	32% (67A)	_____
Hardness	Shore A	_____	80± 3
Compress. Strength 5% deflection	ASTM D695	_____	1442 psi min. 96% min.
Resiliance, %			
Adhesion Properties Bond to concrete		_____	422 psi min.
Ozone Resistance	ASTM D1149	No Cracks	No Cracks
Water Absorption	ASTM D570	_____	2%
U.V. Resistance	_____	Excellent	Excellent

INSTALLATION

Preliminary: Blockouts to receive the Iso-Flex J Series Winged Expansion Joint System must be clean, dry, sound, relatively smooth and free of voids, ridges, and sharp projections. Joint openings and blockouts must be properly sized.

Preparation: The blockouts must be sandblasted just prior to application of the Iso-Flex Primer #10. The primer must be applied to all concrete surfaces that will come in contact with the Iso-Flex 910 Tack Coat and the Iso-Flex 900 Elastomeric Concrete header material.

Fire Barrier: The fire barrier must be sized to meet UL certification. The fire barrier blanket is unrolled, then folded and compressed into the joint gap opening. The fire barrier must be recessed in the breakout to allow room for the J Series seal.

Expansion Joint Installation: Begin by installing the seal into the joint opening. With the blackout primed, mix the 910 Tack Coat material and then gun under the wings in sufficient amount to flow up through the perforations. After the Tack Coat is firmed up, the Iso-Flex 900 Elastomeric Concrete Header can then be mixed installed and tooled to a smooth surface.

PRECAUTIONS

To ensure safe installation of the Iso-Flex Winged Expansion Joint Sealing Systems, please refer to the Material Data Safety Sheet for detailed health and safety information prior to use.

MAINTENANCE

Iso-Flex J Series Winged Expansion Joint Sealing Systems may be easily repaired while in service using methods recommended by the manufacturer.

WARRANTY

LymTal warrants that its products are manufactured free of defects and conform to the technical data listed. Under this warranty we will replace, at no charge, any material proven defective when applied in accordance with our written instructions for applications recommended by us as suitable for subject product. LymTal shall not be liable for any injury, loss or damage, direct or consequential, arising out of the use of the product.

Revised 07/12

SEAL TYPE	MOVEMENT RANGE	SYSTEM DEPTH	JOINT OPENING SIZE (X)		INSTALLATION WIDTH			MIN. SLAB DEPTH
			Minimum (x)	Maximum (x)	Minimum	Mid-Range	Maximum	
J23L	2.000	2.250	0.625	2.625	1.000	1.500	2.375	5.000
	50.800	57.150	15.875	66.675	25.400	38.100	60.325	127.001
J30L	2.750	2.500	0.750	3.500	1.500	2.000	3.250	5.000
	69.850	63.500	19.050	88.900	38.100	50.800	82.550	127.001
J40L	3.000	2.750	1.500	4.500	2.000	3.000	4.250	5.000
	76.200	69.850	38.100	114.300	50.800	76.200	107.950	127.001
J50L	3.750	3.000	1.750	5.500	2.500	4.000	5.250	6.000
	95.250	76.200	44.450	139.701	63.500	101.600	133.351	152.401
J60L	3.500	3.000	3.000	6.500	3.500	5.000	6.250	6.000
	88.900	76.200	76.200	165.101	88.900	127.001	158.751	152.401
J70L	4.000	3.250	3.000	7.000	3.500	5.000	6.750	6.000
	101.600	82.550	76.200	177.801	88.900	127.001	171.451	152.401

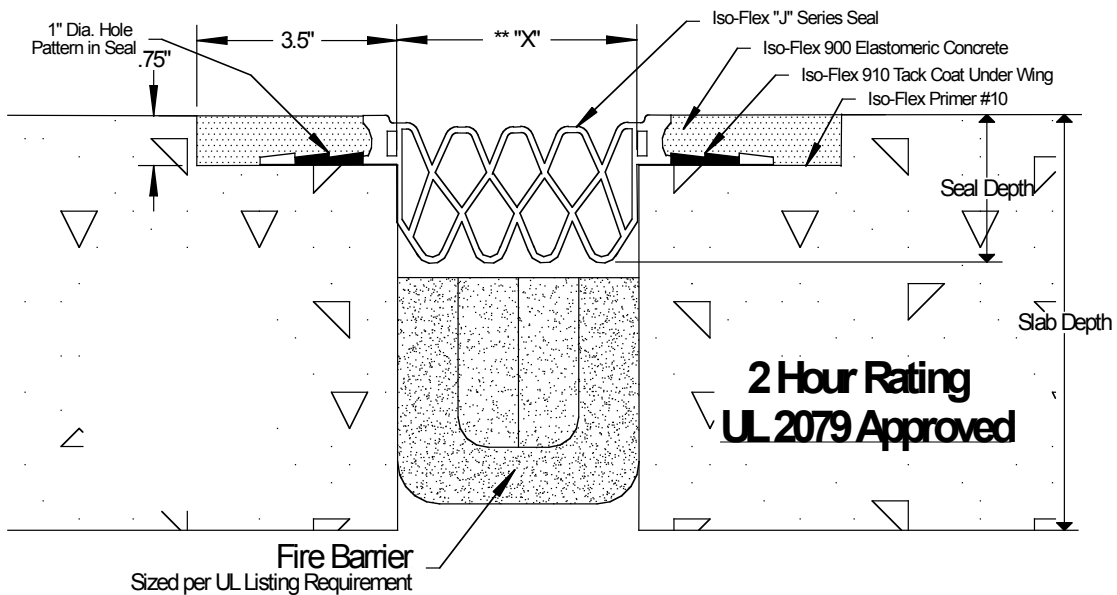

LymTal International, Inc.

4150 South Lapeer Road • Lake Orion, MI 48359 • Tel (248) 373-8100 • Fax (248) 373-3480 • www.lymtal.com